



# Instruction Manual

## Purrfect Paws Kitty



VTech understands that a child's needs and abilities change as they grow and with that in mind we develop our toys to teach and entertain at just the right level...

## **vtech** Baby

Toys that will stimulate their interest in different textures, sounds and colours

### I am...

...responding to colours, sounds and textures

...understanding cause and effect

...learning to touch, reach, grasp, sit-up, crawl and toddle

Birth-36 months



## **Pre-School**

Interactive toys to develop their imagination and encourage language development

### I want...

...to get ready for school by starting to learn the alphabet and counting

...my learning to be as fun, easy and exciting as can be

...to show my creativity with drawing and music so my whole brain develops

3-6 years



## **Electronic Learning Computers**

Cool, aspirational and inspiring computers for curriculum related learning

### I need...

...challenging activities that can keep pace with my growing mind

...intelligent technology that adapts to my level of learning

...National Curriculum based content to support what I'm learning at school

4-10 years



To learn more about this and other VTech® products, visit [www.vtech.co.uk](http://www.vtech.co.uk)

# INTRODUCTION

Thank you for purchasing the **VTech® Purrfect Paws Kitty!**

This cute kitty can be pulled or pushed along for fun reactions! Press the interactive buttons for fun phrases about numbers, body parts and music.

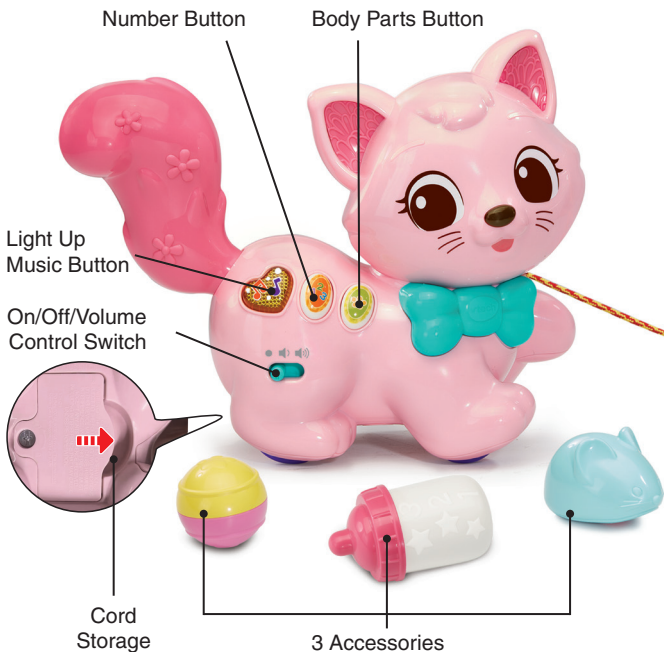

# INCLUDED IN THE PACKAGE

- Purrfect Paws Kitty
- 3 accessories
- Quick Start Guide

## WARNING

All packing materials such as tape, plastic sheets, packaging locks, removable tags, cable ties, cords and packaging screws are not part of this toy, and should be discarded for your child's safety.

## NOTE

Please save this Instruction Manual as it contains important information.

## Unlock the Packaging Locks

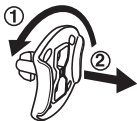

- ① Rotate the packaging lock 90 degrees anticlockwise.
- ② Pull out the packaging locks and discard.

# GETTING STARTED

## Battery Removal and Installation

1. Make sure the unit is turned **Off**.
2. Locate the battery cover on the back of the unit, use a screwdriver to loosen the screw and then open the battery cover.
3. Remove the old batteries by pulling up on one end of the batteries.
4. Install 2 new AAA (AM-4/LR03) batteries following the diagram inside the battery box. (For best performance, alkaline batteries or fully charged Ni-MH rechargeable batteries are recommended.)
5. Replace the battery cover and tighten the screw to secure.

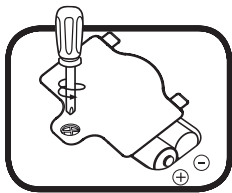

### WARNING:

Adult assembly required for battery installation.  
Keep batteries out of reach of children.

## IMPORTANT: BATTERY INFORMATION

- Insert batteries with the correct polarity (+ and -).
- Do not mix old and new batteries.
- Do not mix alkaline, standard (carbon-zinc) or rechargeable batteries.
- Only batteries of the same or equivalent type as recommended are to be used.
- Do not short-circuit the supply terminals.
- Remove batteries during long periods of non-use.
- Remove exhausted batteries from the toy.
- Dispose of batteries safely. Do not dispose of batteries in fire.

## RECHARGEABLE BATTERIES:

- Remove rechargeable batteries (if removable) from toy before charging.
- Rechargeable batteries are only to be charged under adult supervision.
- Do not charge non-rechargeable batteries.

## Disposal of batteries and product



The crossed-out wheellie bin symbols on products and batteries, or on their respective packaging, indicates they must not be disposed of in domestic waste as they contain substances that can be damaging to the environment and human health.



The chemical symbols Hg, Cd or Pb, where marked, indicate that the battery contains more than the specified value of mercury (Hg), cadmium (Cd) or lead (Pb) set out in the Batteries and Accumulators Regulation.

The solid bar indicates that the product was placed on the market after 13th August, 2005.

 Please dispose of your product and batteries responsibly.

In the UK, give this toy a second life by disposing of it at a small electricals collection point\* so all of its materials can be recycled.

Learn more at:

[www.vtech.co.uk/recycle](http://www.vtech.co.uk/recycle)

[www.vtech.com.au/sustainability](http://www.vtech.com.au/sustainability)

\* Visit [www.recyclenow.com](http://www.recyclenow.com) to see a list of collection points near you.

# PRODUCT FEATURES

## 1. On/Off/Volume Control Switch

To turn the unit **On**, slide the **On/Off/Volume Control Switch** to the Low volume (🔊) or High volume (🔊🔊) position. You will hear a fun sound, phrases and a song. To turn the unit **Off**, slide the **On/Off/Volume Control Switch** to the **Off** ● position.

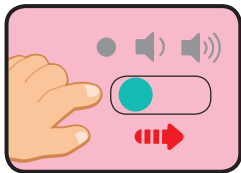

## 2. Pull Cord Storage

To change kitty from a pull toy to a push toy, store the pull cord by opening the battery compartment and tucking the cord inside. To use as a pull toy again, open the battery compartment and extend the cord. Lay the cord in the notch and close the battery compartment. For your child's safety, we suggest you store the pull cord in the compartment until your child is walking and to supervise your child when playing with the pull cord.

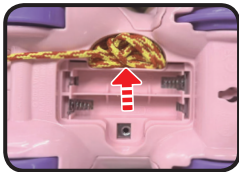

## 3. Automatic Shut-Off

To preserve battery life, the unit will power down after approximately 35 seconds without input. The unit can be turned on again by pressing any button.

## NOTE

If the unit powers down or if the light fades out during play, please install a new set of batteries.

# ACTIVITIES

## 1. Light Up Music Button

Press the Music Button to hear different familiar melodies. The lights will flash with the sounds.

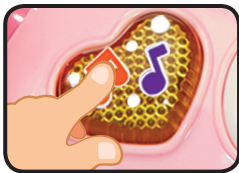

## 2. Number Button

Press the Number Button to learn number counting. The lights will flash with the sounds.



## 3. Body Parts Button

Press the Body Parts Button to hear facts about the kitty.



## 4. Swinging Tail and Motion Sensor

Pull and push the kitty to swing the tail and hear fun sounds.





# MELODY LIST

1. Three little kittens
2. Hey Diddle Diddle
3. Hickory Dickory Dock
4. Au Clair de la Lune
5. London Bridge
6. Pussy Cat Pussy Cat
7. Skip to My Lou
8. Yankee Doodle
9. MacNamara's Band
10. Old King Cole

## SONG LYRICS

### Song 1

I'm a cute kitty, take me to play.  
I like to follow you all the day!

### Song 2

When we play, I wave my tail,  
When I'm happy, I love to purr!

### Song 3

I like to bounce and I like to pounce,  
chasing the mouse and ball is so much fun!

## CARE & MAINTENANCE

1. Keep the unit clean by wiping it with a slightly damp cloth.
2. Keep the unit out of direct sunlight and away from any direct heat sources.
3. Remove the batteries if the unit will not be in use for an extended period of time.
4. Do not drop the unit on hard surfaces and do not expose the unit to moisture or water.

## TROUBLESHOOTING

If for some reason the program/activity stops working or malfunctions, please follow these steps:

1. Please turn the unit **Off**.
2. Interrupt the power supply by removing the batteries.
3. Let the unit stand for a few minutes, then replace the batteries.
4. Turn the unit **On**. The unit should now be ready to play with again.
5. If the unit still does not work, install a new set of batteries.

If the problem persists, please contact our Consumer Services Department and a service representative will be happy to help you

# CONSUMER SERVICES

Creating and developing **VTech®** products is accompanied by a responsibility that we at **VTech®** take very seriously. We make every effort to ensure the accuracy of the information, which forms the value of our products. However, errors sometimes can occur. It is important for you to know that we stand behind our products and encourage you to call our Consumer Services Department with any problems and/or suggestions that you might have. A service representative will be happy to help you.

## **UK Customers:**

Phone: 0330 678 0149 (from UK) or +44 330 678 0149 (outside UK)

Website: [www.vtech.co.uk/support](http://www.vtech.co.uk/support)

## **Australian Customers:**

Phone: 1800 862 155

Website: [support.vtech.com.au](http://support.vtech.com.au)

## **NZ Customers:**

Phone: 0800 400 785

Website: [support.vtech.com.au](http://support.vtech.com.au)

# PRODUCT WARRANTY/ CONSUMER GUARANTEES

## **UK Customers:**

Read our complete warranty policy online at [vtech.co.uk/warranty](http://vtech.co.uk/warranty).

## **Australian Customers:**

**VTECH ELECTRONICS (AUSTRALIA) PTY LIMITED –  
CONSUMER GUARANTEES**

Under the Australian Consumer Law, a number of consumer guarantees apply to goods and services supplied by VTech Electronics (Australia) Pty Limited. Please refer to [vtech.com.au/consumerguarantees](http://vtech.com.au/consumerguarantees) for further information.

**Visit our website for more  
information about our products,  
downloads, resources and more.**

***www.vtech.co.uk***  
***www.vtech.com.au***

